

EXPLODED VIEW - 4G HOB ASSEMBLY

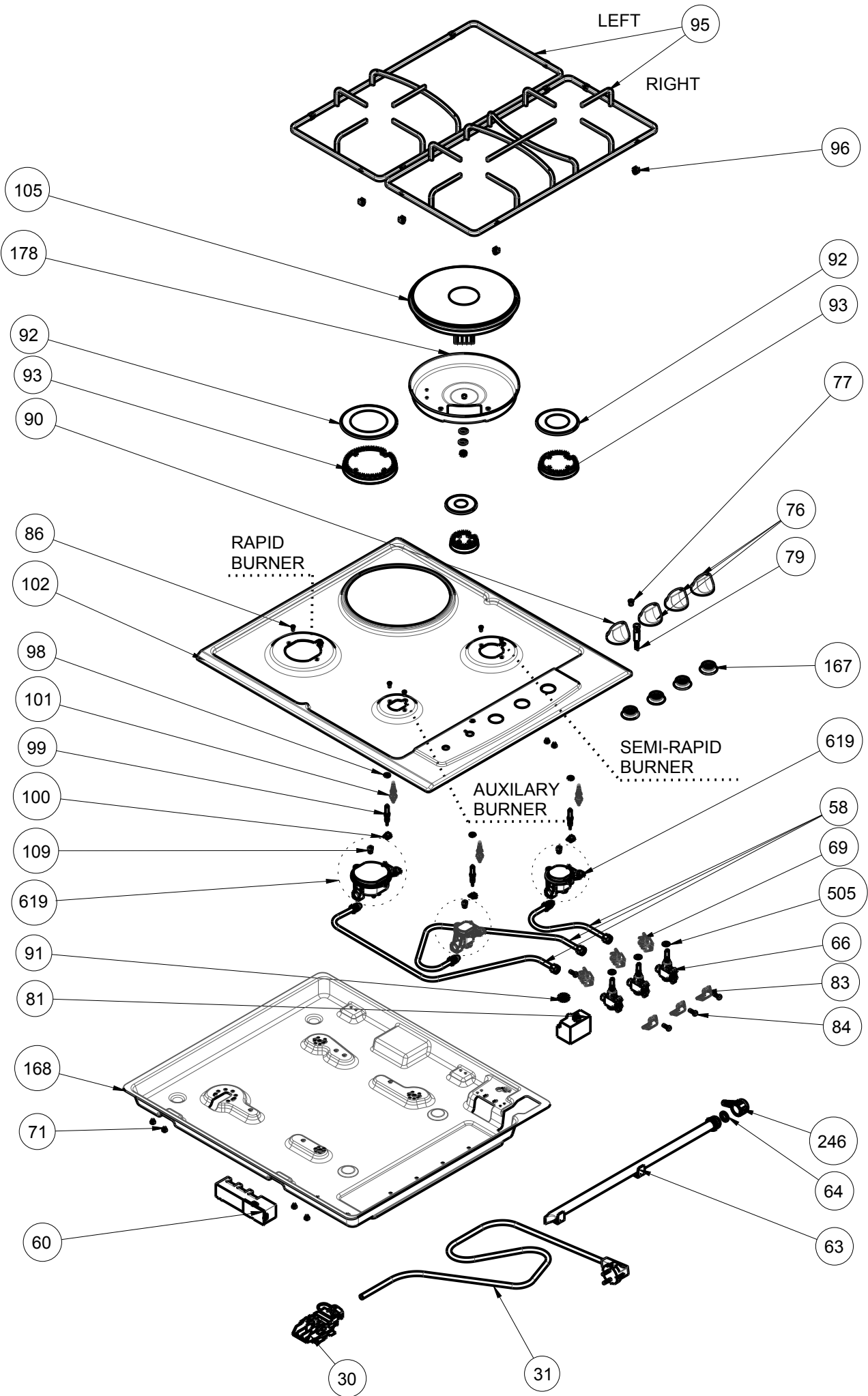

EXPLODED VIEW - 3G1E HOB ASSEMBLY

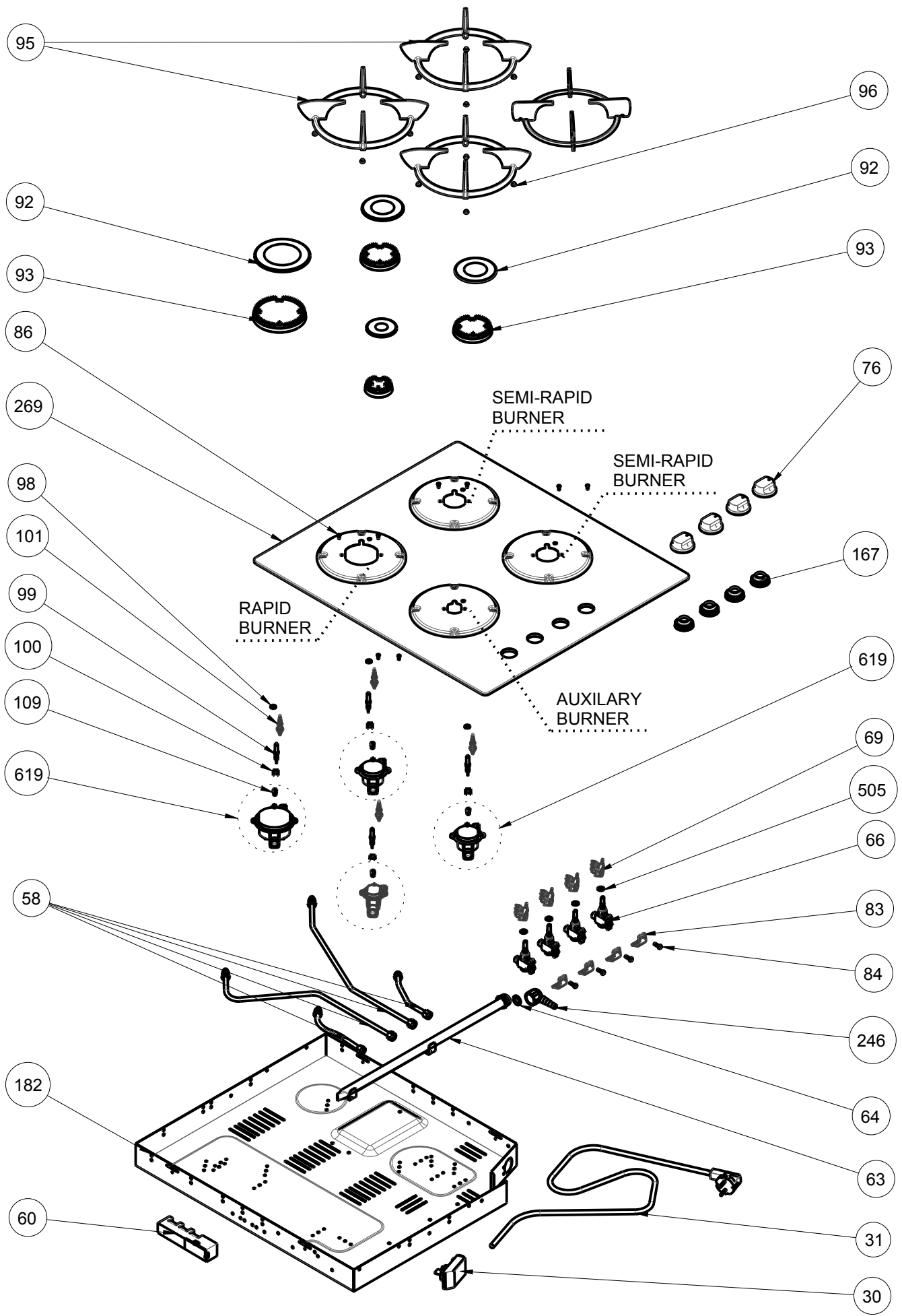

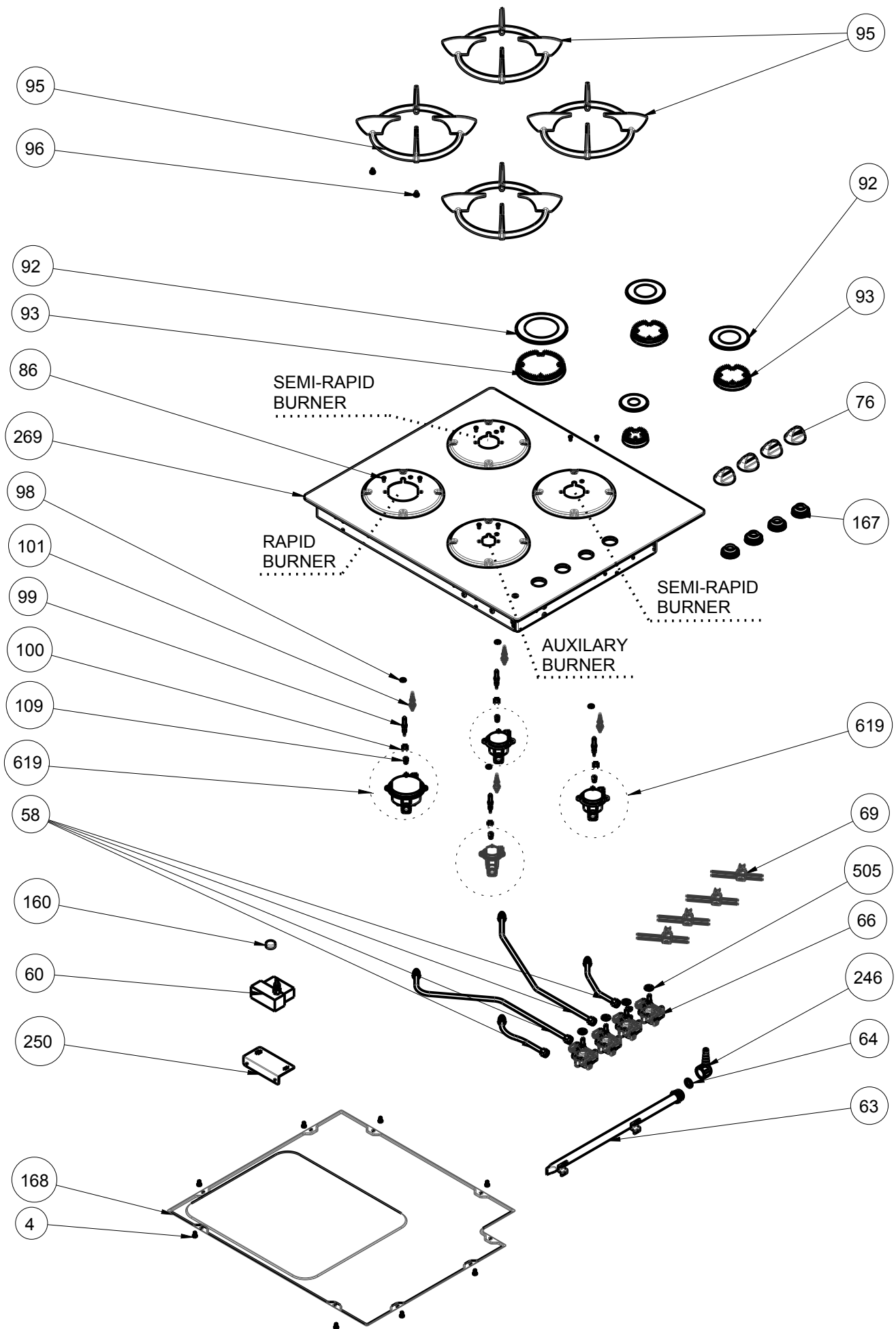

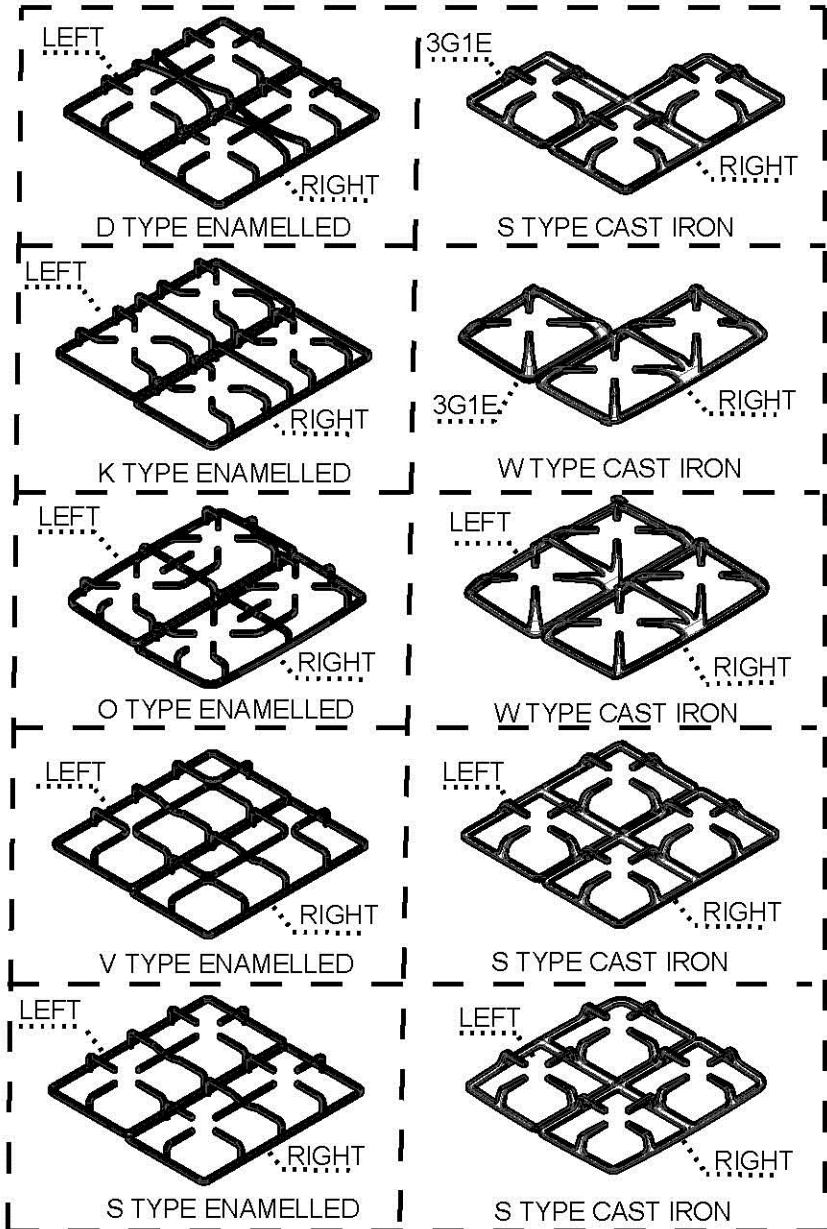

PAN SUPPORTS (OPTIONAL)

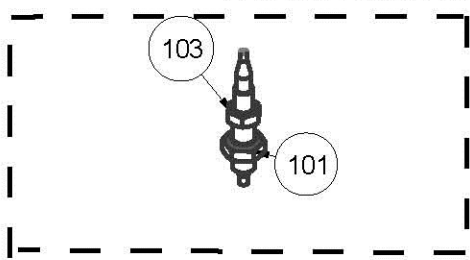

THERMOCOUPLE (OPTIONAL)

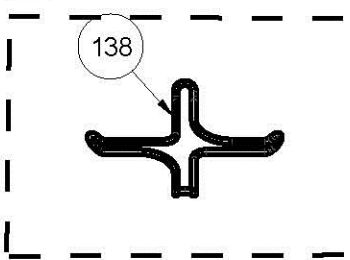

ETHNIC COFFEEPOT SUPPORT (OPTIONAL)

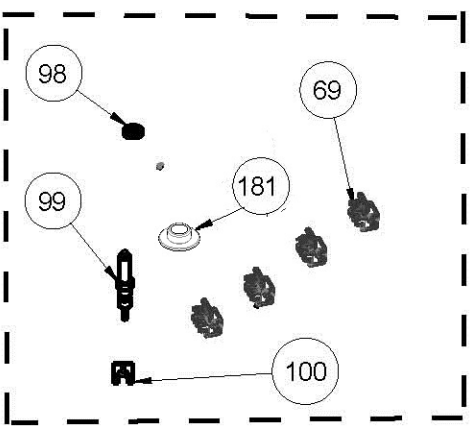

MICRO SWITCH (OPTIONAL)

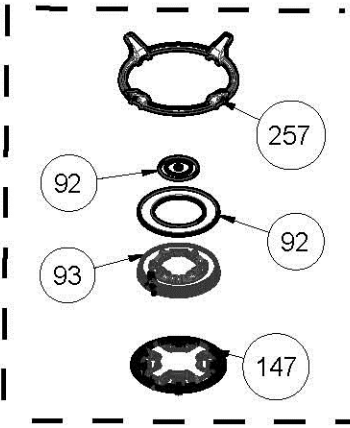

WOK BURNER (OPTIONAL)

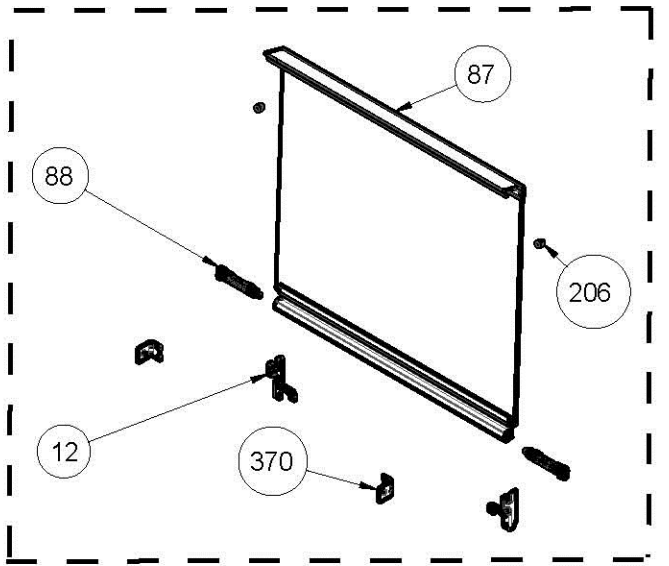

GLASS LID OPTIONAL (AVAILABLE ONLY FOR FRAMED HOBS)

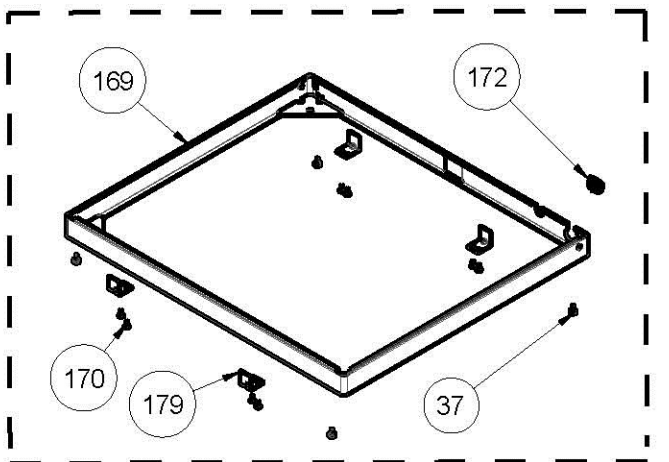

COOKTOP FRAME (ONLY FOR TABLE-TOP HOBS)

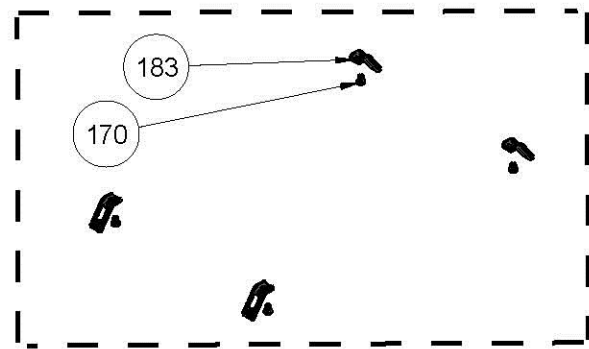

ASSEMBLY BRACKET (ONLY FOR BUILT-IN HOBS)

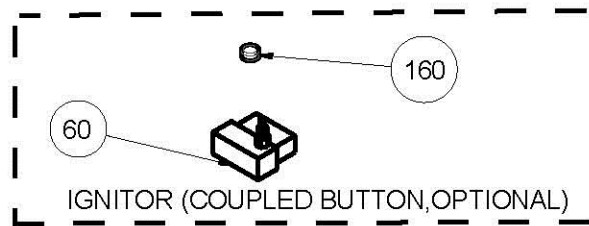

IGNITOR (COUPLED BUTTON, OPTIONAL)

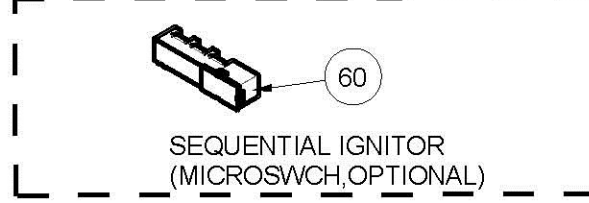

SEQUENTIAL IGNITOR (MICROSWCH, OPTIONAL)

GAS HOBS IGNITION SYSTEMS

KNOBS (ONLY FOR HOB - OPTIONAL)

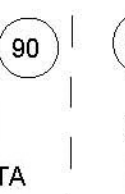
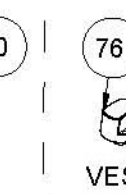
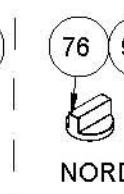
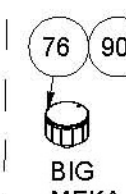
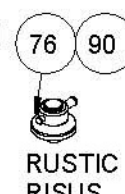
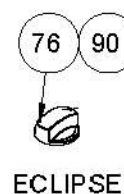
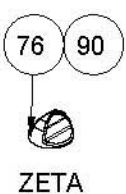
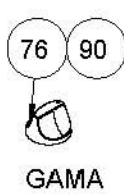
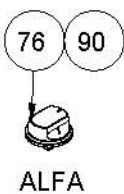
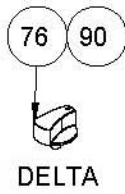

POSITION NUMBER	PART NAME
4	SCREW (3.9*9.5)
12	GLASS LID HINGE COUNTERPART (RIGHT / LEFT)
30	TERMINAL BOX
31	POWER CORD
37	DRAWER PANEL STOPER
58	GAS DELIVERY TUBE
60	IGNITOR (SEQUENTIAL IGNITION / COUPLED BUTTON)
63	MANIFOLD
64	STRAIGHT HOSE FITTING GASKET
66	COOKTOP VALVE
69	MICROSWITCH HARNESS
71	SCREW (3.9*6.5)
76	KNOB (GAS)
79	SIGNAL LAMP BODY
81	BLOCK SWITCH
83	C (/ 365) TOP VALVE ASSEMBLY BRACKET
84	C (/ 365) TOP VALVE ASSEMBLY BRACKET CONTACT SCREW
86	BURNER BODY CONTACT SCREW
87	GLASS LID ASSEMBLY
88	GLASS LID HINGE (RIGHT / LEFT)
90	KNOB (ELECTRICAL)
91	NUT
92	BURNER CAP (SEMI-RAPID / RAPID / AUXILARY / WOK BURNER)
93	BURNER HEAD (SEMI-RAPID / RAPID / AUXILARY / WOK BURNER)
95	PAN SUPPORT
96	PAN SUPPORT BUMPER
98	SPARK PLUG GASKET
99	SPARK PLUG WITH CABLE
100	SPARK PLUG SEGMENT
101	THERMOCOUPLE
102	COOKTOP
103	THERMOCOUPLE FIXING NUT
105	HOTPLATE
107	RONDELA
109	INJECTOR (SEMI-RAPID / RAPID / AUXILARY BURNER)
138	ETHNIC COFFEEPOT SUPPORT
160	IGNITOR BUTTON
167	KNOB GASKET
168	COOKTOP BOTTOM COVER (GAS)
169	COOKTOP FRAME
170	SCREW (4.2*9.5)
172	CABLE COVER PLASTIC
178	HOTPLATE HOUSING
179	COOKTOP FRAME BRACKET
181	MICROSWITCH STOPER
183	BUILT-IN HOB ASSEMBLY BRACKET
206	GLASS LID FRO. PROFILE SILICON BUMPER
246	MANIFOLD ANGLE IRON 1/2"
257	WOK BURNER SUPPORT
269	GAS-ON GLASS ASSEMBLY
370	LID HINGE COUNTERPART SUPPORT (RIGHT / LEFT)
619	BURNER BODY (SEMI-RAPID / RAPID / AUXILARY / WOK BURNER)

"The exploded views given in this document are generic. They include all possible versions of the product. For specific part codes, please refer to the bom list of regarding model."