

# 90 CM SECURIT GAS HOB

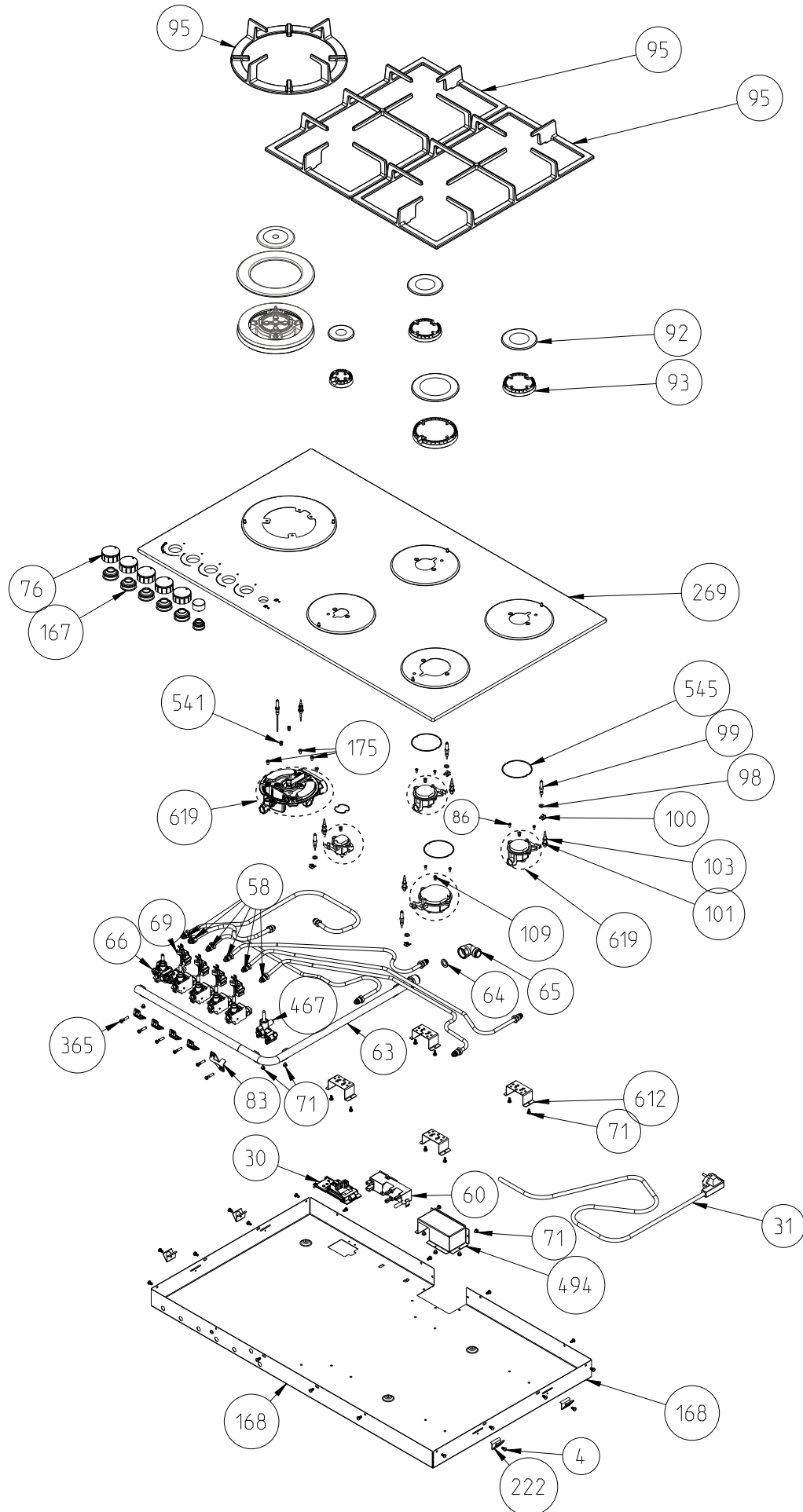

The exploded views given in this document are generic. They include all possible versions of the product. For specific part codes, please refer to the born list of regarding model.

<b>HOB ASSEMBLY PARTS</b>	
<b>POSITION NUMBER</b>	<b>PART NAME</b>
4	SCREW (KNURLED, 3.9*9.5)
58	GAS DELIVERY TUBE
30	TERMINAL BOX
31	POWER CORD
60	IGNITOR
63	MANIFOLD
64	STRAIGHT HOSE FITTING GASKET
65	HOSE FITTING 1/2" NG
66	COOKTOP VALVE
69	MICROSWITCH HARNESS
71	SCREW (KNURLED, 3.9*6.5)
76	KNOB (GAS)
83	COOKTOP VALVE ASSEMBLY BRACKET
84	COOKTOP VALVE ASSEMBLY BRACKET CONTACT SCREW
86	BURNER BODY CONTACT SCREW
92	BURNER CAP (SEMI-RAPID/RAPID/AUXILLIARY BURNER)
93	BURNER HEAD (SEMI-RAPID/RAPID/AUXILLIARY BURNER)
95	PAN SUPPORT
98	SPARK PLUG GASKET
99	SPARK PLUG WITH CABLE
100	SPARK PLUG SEGMENT
101	THERMOCOUPLE
103	THERMOCOUPLE FIXING NUT
109	INJECTOR(SEMI-RAPID/RAPID/AUXILLIARY/WOK BURNER)
167	KNOB GASKET
168	COOKTOP BOTTOM COVER(GAS)
175	BURNER BODY CONTACT SCREW (WOK BURNER)
222	HOB ASSEMBLY SPRING
269	SECURIT GLASS ASSEMBLY
365	COOKTOP VALVE ASSEMBLY BRACKET CONTACT SCREW
467	MAIN SWITCH
494	90 SEC BOTTOM COVER ARTICULATION COMPNT
541	INJECTOR (WOK)
545	BURNER GASKET
612	BURNER HOLDER
619	BURNER BODY(SEMI-RAPID/RAPID/WOK/AUXILLIARY BURNER)

The exploded views given in this document are generic. They include all possible versions of the product. For specific part codes, please refer to the bom list of regarding model.